



# CoreLine Projector gen2

## ST151T LED30S/940 MB WH

25 degree(s), 940 neutral white, Power supply unit (On/Off),  
White

The well-known CoreLine Projector with its latest generation has undergone important design and performance improvement, raising the bar even higher and setting a new standard for track projectors used in retail and hospitality applications.

### Warnings and Safety

- The luminaire should be mounted outside of arm's reach
- The luminaire should be installed by a qualified electrician and wired in accordance with the latest IEE electrical regulations or the national requirements

### Product data

| General Information      |                                   |
|--------------------------|-----------------------------------|
| Light source replaceable | No                                |
| Number of gear units     | Unit                              |
| Driver included          | Yes                               |
| Lighting Technology      | LED                               |
| Value ladder             | Value                             |
| CE mark                  | Yes                               |
| Warranty period          | 5 years                           |
| Flammability mark        | -                                 |
| ENEC mark                | ENEC mark                         |
| Glow-wire test           | Temperature 650 °C, duration 30 s |
| EU RoHS compliant        | Yes                               |

| Light Technical                  |                   |
|----------------------------------|-------------------|
| Luminous Flux                    | 3,000 lm          |
| Saturated Red (R9)               | >50               |
| Correlated Colour Temperature    | 4000 K            |
| Luminous efficacy (rated) (nom.) | 110 lm/W          |
| Colour rendering index (CRI)     | >90               |
| Flickering value (PstLM)         | 1                 |
| Stroboscopic effect              | 1.6               |
| Beam angle of light source       | 25 degree(s)      |
| Light source colour              | 940 neutral white |
| Optic type                       | Wide beam         |
| Luminaire light beam spread      | 25°               |

## CoreLine Projector gen2

|  |                            |
|--|----------------------------|
| Unified Glare Rating (CEN)               | 20                         |
| <b>Operating and Electrical</b>          |                            |
| Input Voltage                            | 220 to 240 V               |
| Line Frequency                           | 50 or 60 Hz                |
| Initial CLO power consumption            | 27 W                       |
| Average CLO power consumption            | 27 W                       |
| Inrush current                           | 43.8 A                     |
| Inrush time                              | 0.0115 ms                  |
| Power Consumption                        | 27 W                       |
| Power Factor (Fraction)                  | 0.9                        |
| Connection                               | 3C Track                   |
| Cable                                    | -                          |
| Number of products on MCB of 16 A type B | 30                         |
| <b>Temperature</b>                       |                            |
| Ambient temperature range                | -20 to +40 °C              |
| <b>Controls and Dimming</b>              |                            |
| Dimmable                                 | No                         |
| Driver/power unit/transformer            | Power supply unit (On/Off) |
| Constant light output                    | No                         |
| <b>Mechanical and Housing</b>            |                            |
| Housing material                         | Aluminium                  |
| Reflector material                       | -                          |
| Optic material                           | Polycarbonate              |
| Optical cover/lens material              | Polycarbonate              |
| Fixation material                        | -                          |
| Housing Colour                           | White                      |
| Optical cover/lens finish                | -                          |
| Overall length                           | 207 mm                     |
| Overall width                            | 87 mm                      |
| Overall height                           | 125 mm                     |
| Overall diameter                         | 80 mm                      |
| Dimensions (height x width x depth)      | 125 x 87 x 207 mm          |

|   |  |
|---|--|
| <b>Approval and Application</b>                 |  |
| Ingress protection code                         | IP20 [Finger-protected]                        |
| Mech. impact protection code                    | IK03 [0.3 J]                                   |
| Sustainability rating                           | -  |
| Protection class IEC                            | Safety class I                                 |
| Photobiological risk                            | Photobiological risk group 0 @200mm to EN62778 |
| Photobiological risk specification              | 0.2 m  |
| <b>Initial Performance (IEC Compliant)</b>      |  |
| Luminous flux tolerance                         | +/-10%   |
| Initial chromaticity                            | (0.3837, 0.3828) SDCM <4                       |
| Power consumption tolerance                     | +/-10%   |
| <b>Over Time Performance (IEC Compliant)</b>    |  |
| Control gear failure rate at median useful life | 0.05 %   |
| 50,000 h  |  |
| Lumen maintenance at median useful life*        | L70  |
| 50,000 h  |  |
| <b>Application Conditions</b>                   |  |
| Performance ambient temperature Tq              | 25 °C  |
| Maximum dim level                               | Not applicable                                 |
| Suitable for random switching                   | No   |
| <b>Product Data</b>                             |  |
| Full EOC  | 871951452858199                                |
| Order product name                              | ST151T LED30S/940 MB WH                        |
| Order code                                      | 52858199                                       |
| SAP numerator – quantity per pack               | 1  |
| Numerator – packs per outer box                 | 10   |
| Material no. (12 NC)                            | 911401846882                                   |
| Full product name                               | ST151T LED30S/940 MB WH                        |
| EAN/UPC – Case                                  | 8719514528666                                  |
| EAN/UPC – Product/Case                          | 8719514528581                                  |

### Dimensional drawing

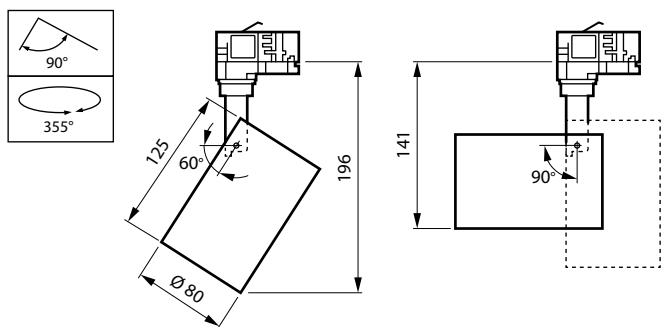

## CoreLine Projector gen2

